

Please Note: If you're new to Revit, you may be interested in my "[Beginner's Guide to Revit Architecture](#)" **84 part video tutorial training course**

. The course is 100% free with no catches or exclusions. You don't even need to sign-up. Just enjoy the course and drop me line if you found it useful. The [full course itinerary can be viewed here](#)

In this article we are going to take a look at how to create a **Surface** form, from within the **Conceptual Design Environment**

. If you are totally new to the Conceptual Design Environment (or CDE) within Revit, I suggest that you may wish to [read this article first](#)

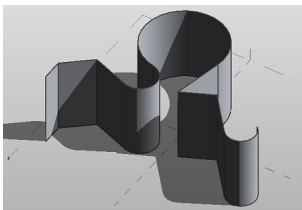

In other articles we have looked at how to create solid 3D forms such as [Lofts](#) , [Sweeps](#) and

Revolves

. But we can also use the “**Create Form > Solid Form**” tool to create a solid planar surface.

Compared with the other solid forms we have looked at, this one is by far the easiest to create- which means this article is going to be pretty short!.

Let's start with a new “**Conceptual Mass**” family template.....

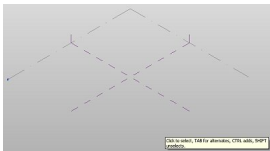

To start with, I am going to create just a single plane- really, just to show you how easy it is. But you can just as easily create far more complex and convoluted surfaces.

First, I simply draw a line. I'm going to use an **Arc**, just to make my Surface a little more interesting. Here is my arc....

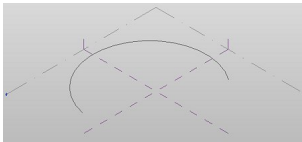

Now with my arc selected, I simply hit the “**Create Form**” button....

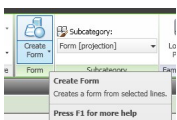

And my Surface form is created like so.....

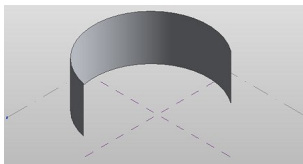

And there you have it! As I said before, you can of course create more complex surfaces by using **multi-segment lines**. Here is an example.....

